

Z1700 SHOKTROLS



ENGINEERING SPECIFICATION

Where required in piping systems, properly sized water hammer arrestors require Zurn Z1700 (specify size). Features nesting type bellows contained within a casing having sufficient displacement volume to dissipate the calculated kinetic energy generated in the piping system. Both casing and bellows are constructed of Type 304 stainless steel.

NOTE:

All sizes of Zurn Z1700 Shoktrol water hammer arrestors comply with the following specifications:
PDI WH-201
ANSI A112.26.1M
ASSE 1010

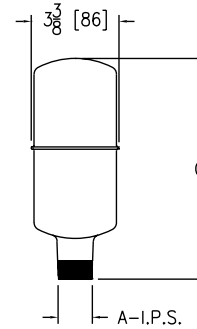

Size	Dimensions in inches [mm]		Approximate Weight lb [kg]	Fixture Unit Capacity
	A	C		
100	3/4 [19]	3-1/2 [89]	1 [0.5]	1-11
200			1-1/2 [0.68]	12-32
300	1 [25]	4-1/2 [114]	1-3/4 [0.79]	33-60
400			2-3/4 [1.25]	61-113
500			3-1/4 [1.5]	114-154
600			3-3/4 [1.7]	155-330

PREFIXES	DESCRIPTION	SIZE	LIST PRICE
Z*	Zurn Shoktrol Water Hammer Arrestors are regularly furnished in all stainless steel construction. Pipe threads are accurately machined to assure tight connection. 3/4" male I.P.S. inlet is standard for sizes 100 and 200, while 1" male I.P.S. inlet is standard for sizes 300 thru 600.	100	527.00
		200	1,063.00
		300	1,600.00
		400	4,002.00
		500	4,518.00
		600	5,552.00

BEST SELLERS		LIST PRICE
Z1700-100		527.00
Z1700-200		1,063.00
Z1700-300		1,600.00
Z1700-400		4,002.00

Z1712 ACCUMUTROL



ENGINEERING SPECIFICATION

Shock associated with solenoid or other quick-closing valves serving heavy equipment, such as laundry machines, dishwashers, etc., shall be controlled by installation of Zurn Z1712 Accumutrol. Comes complete with floating stainless steel spherical piston, surge chamber, valve and gauge assembly. Specify size and location.

NOTE:

Maximum temperature 500°F. Maximum pressure 200 PSI residual.

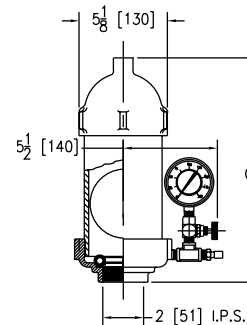

Size	C inches [mm]	Approximate Weight lb [kg]
2000	13 [330]	20 [9]
4000	21 [533]	28 [13]
6000	29 [737]	36 [16]
8000	37 [940]	44 [20]
10000	45 [1143]	52 [24]
12000	53 [1346]	60 [27]
14000	61 [1549]	68 [31]
16000	69 [1753]	76 [34]

PREFIXES	DESCRIPTION	SIZE	LIST PRICE
Z*	Bronze surge chamber, Viton valve seat and stainless steel spherical piston.	2000	6,445.00
		4000	7,466.00
		6000	8,561.00
		8000	10,419.00
		10000	12,018.00
		12000	13,620.00
	14000	20,363.00	
	16000	22,479.00	

BEST SELLERS		LIST PRICE
Z1712-2000		6,445.00
Z1712-6000		8,561.00